

# 294 Bay View Road – Floor Plan & Key Stats

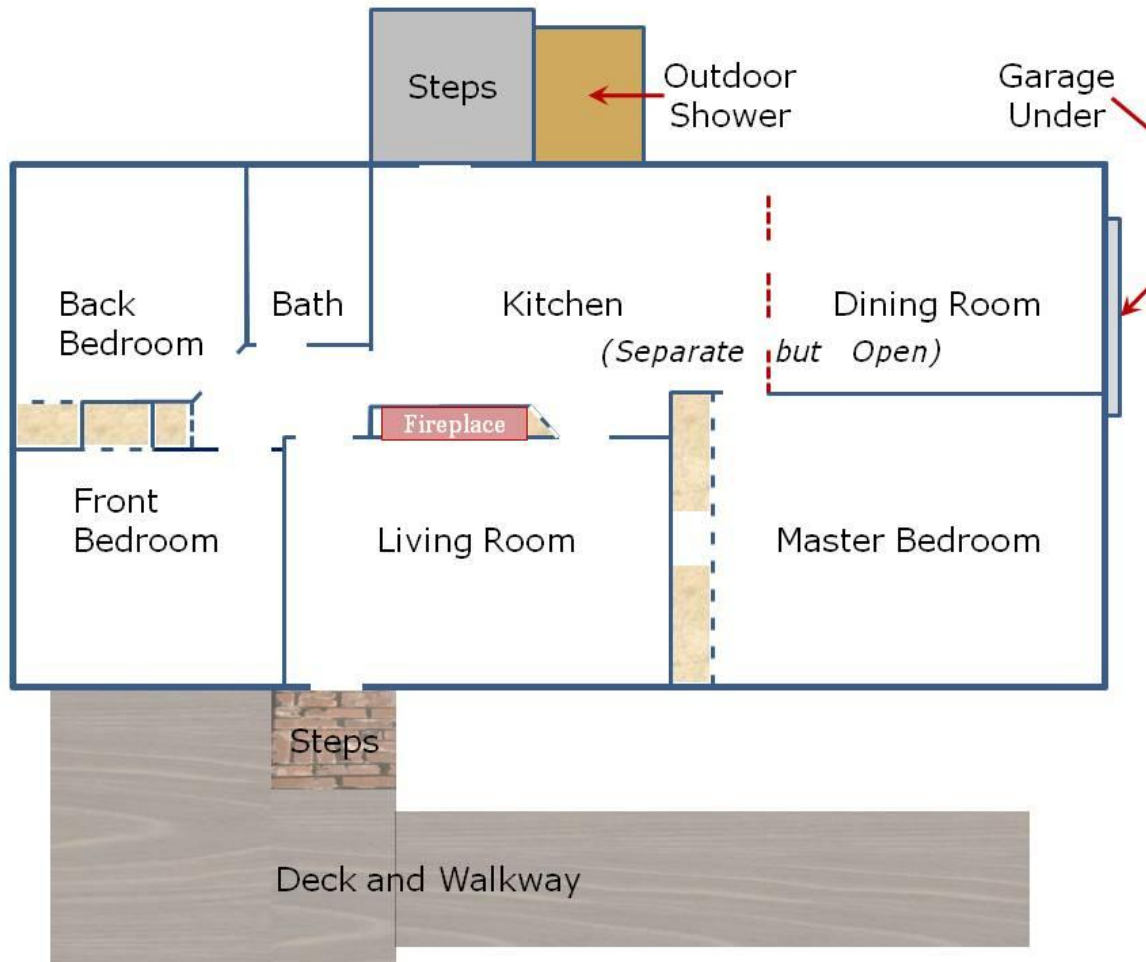

Year Built	1950
Lot Size	8,880 SqFt
Living Area	1,200 SqFt
# Rooms	6
# Bedrooms	3
# Bathrooms	1
Garage	Under (1 Car)
Tax Assessment	\$865,550

Foundation	50.0 ft	by	24.0 ft
Back Bedroom	11.0 ft	by	11.0 ft
Front Bedroom	12.5 ft	by	11.0 ft
Bath	5.5 ft	by	8.0 ft
Kitchen	17.5 ft	by	11.5 ft
Dining Room	15.0 ft	by	10.5 ft
Living Room	17.5 ft	by	9.5 ft
Master Bedroom	18.0 ft	by	13.0 ft

\*\*\*

*Room sizes do NOT include most closet or cabinet space.*

*All shapes and room sizes are approximate.*

*Buyer must verify all measurements.*